

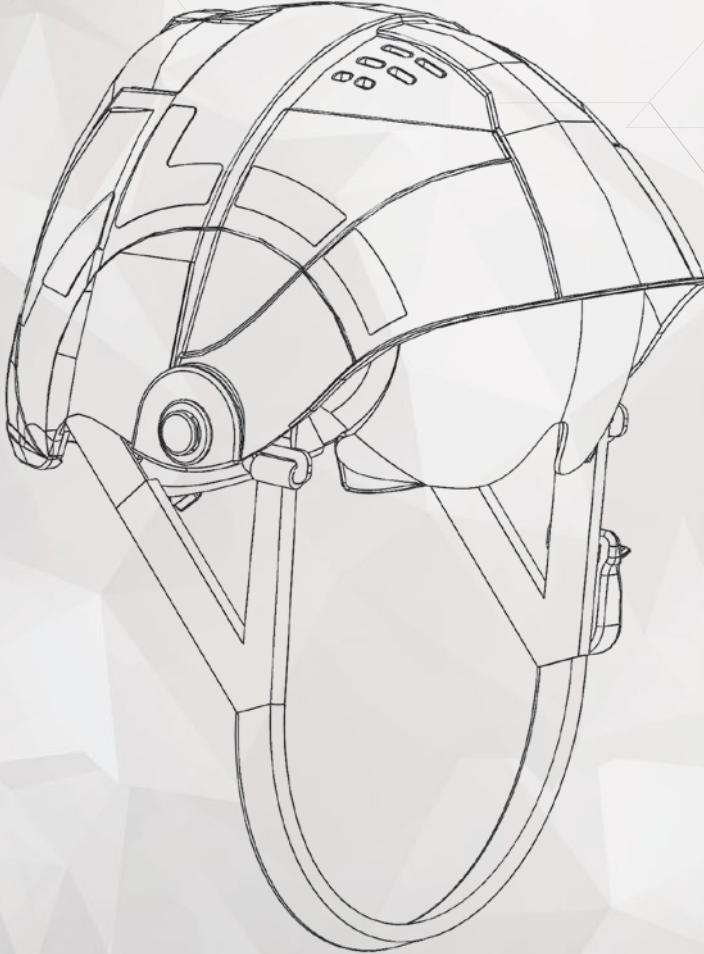

PAB Akrapović

PAB MP1 Professional

· user manual ·



Helmet for wildland firefighting, technical rescue,
mountaineering, canoeing and white-water sports

CERTIFICATES: EN 16471 | EN 16473 | EN 12492 | EN 1385 | EN 166 | EN 14458

When conditions are at their worst,
we are at our best.

THINKING AHEAD

firefighting & safety helmet series

EXPLODED VIEW	5
SAFETY NOTICE	6
TECHNICAL DATA	9
CERTIFICATIONS AND TECHNICAL SPECIFICATIONS	10
UNPACKING	12
FITTING AND ADJUSTING THE HELMET	12
REMOVING THE HELMET	16
ADJUSTING THE INTEGRATED INTERNAL GOGGLES AND FACE SHIELD *	17
ATTACHING THE SAFETY GOGGLES*	19
ATTACHING THE NECK PROTECTORS (*Optional)	20
MOUNTING THE LAMP HOLDERS AND LAMPS (*Optional)	21
SERVICING AND MAINTENANCE	23
FACE SHIELD REPLACEMENT	27
STORAGE AND TRANSPORT	28
SERVICE LIFE AND DISCARD	28
WARRANTY	29

PAB MP1 Professional

We thank you for selecting a PAB Akrapović product.

PAB Helmet MP1 Professional is in conformity with Regulation (EU) 2016/425, with reference to standards EN 16471:2014, EN 16473:2014, EN 12492:2012 and EN 1385:2012. PAB MP1 Professional also meets clauses: 5.1.1, 5.2.1, 5.2.4 and 5.2.5 of EN 397:2012+A1 (2012) standard. The integrated goggles and optionally available face visor meet standards EN 14458:2004 and EN 166:2001.

It has been designed to protect the head under the most extreme conditions. It has an optimal relationship between protection and comfort with a broad spectrum of optional upgrades.

It is a multi-purpose helmet, offering high standard of protection and comfort with accessories that further widen the possibility of customisation. Designed for outland and wildland firefighting, rescue service activities, EMS activities, mountaineering, canoeing and white-water sports.

- ① **MP1 SHELL**
- ② **IMPACT LINER**
- ③ **INTERIOR BASKET**
- ④ **ADJUSTABLE NECK PIECE with REGULATOR**
- ⑤ **HEADBAND PAD**
- ⑥ **HEAD PAD**
- ⑦ **CHINSTRAP**
- ⑧ **REFLECTIVE STICKERS**
- ⑨ **LAMP ***
- ⑩ **LAMP HOLDERS ***
- ⑪ **FACE SHIELD/VISOR ***
- ⑫ **INTERNAL GOGGLES**
- ⑬ **NECK PROTECTOR ***

*Optional Accessory

EXPLODED VIEW

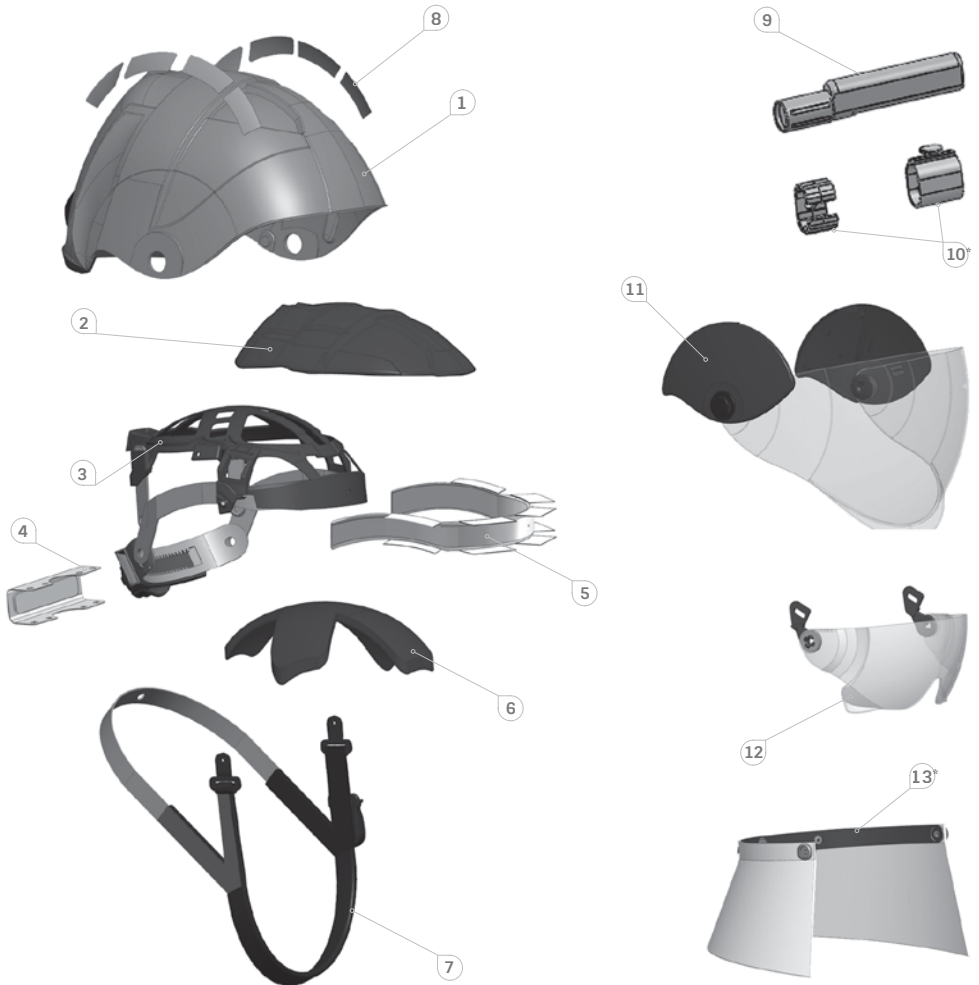

Picture 1

PAB MP1 Professional

SAFETY NOTICE



Important!

PAB MP1 Professional is a safety helmet intended for wildland firefighting, technical rescue interventions, mountaineering, canoeing and whitewater sports.

Read the instructions carefully before wearing the helmet.

For adequate protection, this helmet has to fit or to be adjusted to the size of the user's head.

The attention of the users is also drawn to the damage of modifying or removing any of the original component parts of the helmet, other than as recommended by the helmet manufacturer. Helmets should not be adapted for the purpose of fitting attachments in any way not recommended by the helmet manufacturer.

This helmet is not intended for use in white water classes 5 and 6 as given by the International Canoe Federation.

This helmet is designed to help protect from bumps, scratches and concussion.

PAB accepts no liability, if the product has been used inappropriately or if it is not used as intended. Product liability claims and warranties made by PAB for the product are voided, if the product is not used, serviced or maintained properly.

Before wearing the helmet you should perform a detailed inspection of the helmet and check if all its components are in their place and properly fixed.

An unusual event may require to replace a product after only one use. This depends on the type and intensity of use, or the environment in which it is used: aggressive environments, extreme temperatures, contact with chemicals, strong impacts...

**Warning:**

Inappropriate use, maintenance or servicing can affect the function of the helmet and can seriously endanger the user's life. The helmet's operability must be checked and verified before each use. The helmet is not to be used if the operability test is unsuccessful, if the helmet is damaged, if proper servicing or maintenance has not been made, or if PAB original spare parts have not been used.

When fitted with another item of personal protective equipment or with an accessory (other than as supplied by the helmet manufacturer for use with this helmet) a helmet marked as complying with EN 16471:2014 and EN 16473:2014 might no longer satisfy all clauses of these standards. Refer to information provided by the helmet manufacturer.

The helmet provides protection of the head against shock, sharp objects, splatters of corrosive chemicals (Sulphuric acid, Sodium hydroxide, p-Xylene, Butan-1-ol, n-Heptane), molten metals, radiating heat, flames, electric current. The user's protection is not guaranteed in situations where the conditions exceed those described in the specifications above.

The helmet is made to absorb the energy of a blow by partial destruction of, or damage to the shell and the harness, and even though such damage may not be readily apparent, any helmet subjected to severe impact should be replaced.

Replace any damaged parts only with original PAB parts, as only these original parts are authorised and ensure the performance of the helmet.

Do not apply paint, solvents, adhesives or self-adhesive labels, except in accordance with instructions from PAB Akrapović.

**Warning:**

The protection intended to be provided by the helmet can only be ensured when it is properly assembled and correctly fitted. Any removable parts shall not be worn separately.

This helmet complies with the retention requirements of EN 16471:2014 and EN 16473:2014 European standards when the chin strap supplied by the helmet manufacturer is worn and adjusted in accordance with these instructions.

PAB MP1 Professional

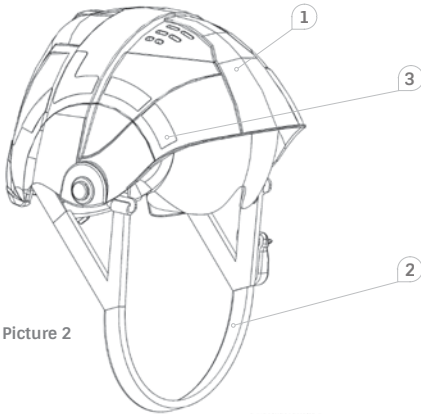

Picture 2

- 1 SHELL MP1
- 2 CHINSTRAP
- 3 REFLECTIVE STICKERS

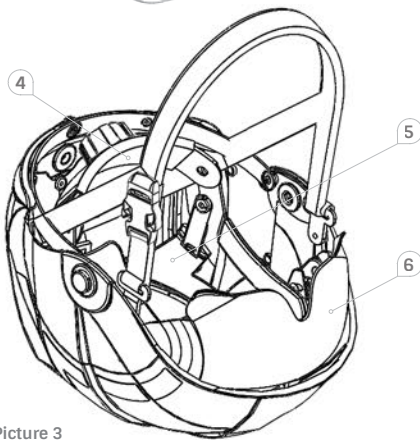

Picture 3

- 4 ADJUSTABLE NECK PIECE WITH REGULATOR
- 5 INTERIOR BASKET
- 6 INTERNAL GOGGLES

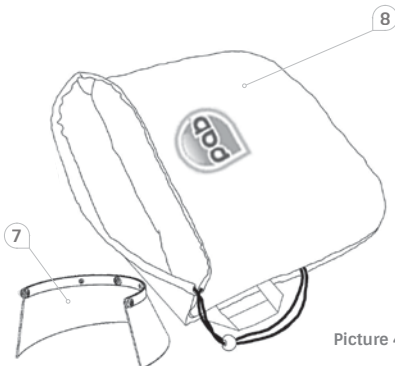

Picture 4

- 7 NECK PROTECTOR *
- 8 TEXTILE BAG FOR STORING AND TRANSPORT

*Optional accessory

TECHNICAL DATA

Helmet sizes	For head sizes from 52 cm to 64 cm (20.5 inches to 25.2 inches)
Weight (helmet with integrated internal goggles and no optional accessories)	850 g ± 30 g The weight may vary depending on the colour (e.g. photoluminescent colour). When optional accessories are fitted to the helmet the weight changes.
Optional accessories	<ul style="list-style-type: none"> • Face shield • Neck protectors: standard versions (leather, aluminised fibre, Nomex or meta-aramid) • Lamp holders • Lamps
Warranty	
<ul style="list-style-type: none"> • Helmet • Optional accessories 	2 years 2 years (this only applies to accessories produced by PAB Akrapović)

The length of the useable life of this helmet will be affected by the types of materials used in its construction and the environments in which the helmet is used and stored. Recommendations on this topic should be sought from the manufacturer.

PAB MP1 Professional

CERTIFICATIONS AND TECHNICAL SPECIFICATIONS

The helmet meets the requirements of Regulation (EU) 2016/425 and is certified according to EN 16471:2014, EN 16473:2014, EN 12942:2012 and EN 1385:2012 standards. The helmet also meets the requirements of clauses 5.1.1, 5.2.1, 5.2.4 and 5.2.5 of EN 397:2012+A1 (2012) standard.

Helmet – Standards, Directives

Certification agency	CSI S.p.A, Viale Lombardia 20/B, 20021 Bollate (MI), Italy, Notified Body No.: 0497	
Directives and Standards	Regulation (EU) 2016/425	Regulation (EU) 2016/425 of the European Parliament and of the Council of 9 March 2016 on personal protective equipment
	EN 16471:2014	“Firefighters helmets – Helmets for wildland fire fighting”
	EN 16473:2014	“Firefighters helmets – Helmets for technical rescue”
	EN 12942:2012	“Helmets for mountaineers”
	EN 1385:2012	“Helmets for canoeing and white water sports”

Integrated internal goggles

Certification agency	CSI S.p.A (0497), Viale Lombardia 20/B, 20021 Bollate (MI), Italy, Notified Body No.: 0497	
Directives and Standards	Regulation (EU) 2016/425	Regulation (EU) 2016/425 of the European Parliament and of the Council of 9 March 2016 on personal protective equipment
	EN 166:2001	“Personal eye protection”
	EN 14458:2004	“Personal eye-equipment – Face shields and visors for use with firefighters’ and high performance industrial safety helmets used by firefighters, ambulance and emergency services “
Markings	3-1,2	Scale number
EN 166:2001	1	Optical class
	B	Resistance to medium energy impact
	8	Resistance to short circuit electric arc
	9	Resistance to molten metals and penetration of hot solids
	K	Resistance to surface damage by fine particles
	N	Resistance to fogging

Markings	17	Year of manufacture
EN 14458:2004	=	General use
	⊙	Eye guard
	3-1,2	Scale number
	-20 °C	Extremes of temperatures to which the eye guard has been tested
	K	Resistance to abrasion
	N	Resistance to fogging
	Ω	Electrical properties
		See manufacturer's information

Face Shield – Standards, Directives and Markings

*The face shield is an optional accessory and the following applies only in case you have purchased a helmet version that includes this accessory.

Certification agency	CSI S.p.A (0497), Viale Lombardia 20/B, 20021 Bollate (MI), Italy, Notified Body No.: 0497	
Directives and Standards	Regulation (EU) 2016/425	Regulation (EU) 2016/425 of the European Parliament and of the Council of 9 March 2016 on personal protective equipment
	EN 14458:2004	“Personal eye-equipment – Face shields and visors for use with firefighters’ and high performance industrial safety helmets used by firefighters, ambulance and emergency services “
Marking	-30°C +120°C	Extremes of temperatures at which the visor has been tested (down to -30°C and up to +120°C)
	⊙	Visor type – face guard
	+	Conforms to the parameters for firefighters
	T	Resistance to medium energy impact at extremes of temperature
	Ω	Complies with electrical properties

PAB MP1 Professional

UNPACKING



Picture 5

- 1 Remove the helmet from the plastic bag.
- 2 Take out the neck protector (if included) and the textile bag.
- 3 Read the instructions carefully before wearing the helmet.
- 4 Perform a detailed inspection of the helmet and check if all its components are in their place and properly fixed before wearing the helmet.

FITTING AND ADJUSTING THE HELMET



Picture 6



Picture 7

1b SNAP-FIT BUCKLE

Open the chin strap - if your helmet configuration includes the snap-fit buckle, press on both sides of the snap-fit buckle to open.

1b CAM BUCKLE

Open the chin strap - if your helmet configuration includes the cam buckle, press the red tab ("PRESS") to release.

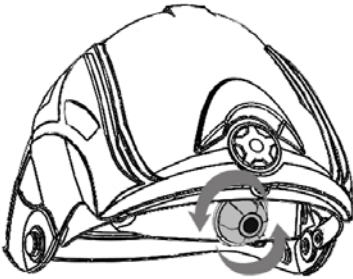

Picture 8

- 2 Loosen the headband: turn the ratchet knob anticlockwise.

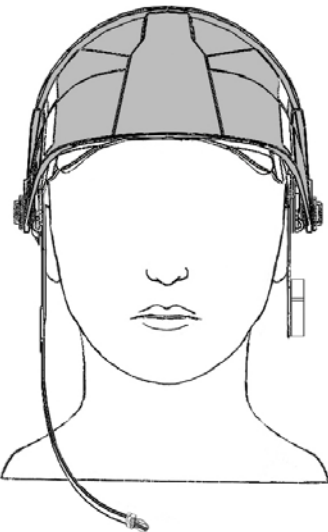

Picture 9

- 3 Firmly place the helmet on the head.

PAB MP1 Professional

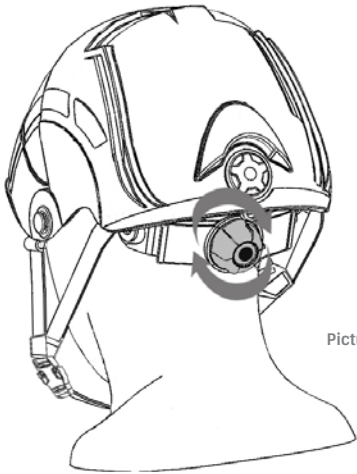

Picture 10

- 4 Tighten the headband: turn the ratchet knob clockwise until the headband is tight but comfortable (fits sizes from 52 to 64 cm). To check whether the headband is correctly adjusted lean your head forward and leave the chin strap unfastened - the helmet shall not fall off.

5b SNAP-FIT BUCKLE

Close/lock the chin strap - if your helmet configuration includes the snap-fit buckle, connect both parts of the buckle to lock the chin strap.

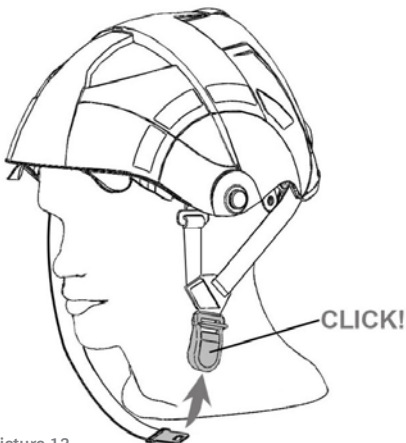

Picture 12

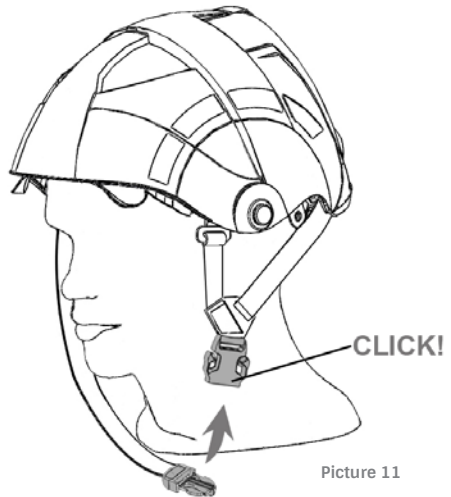

Picture 11

5b CAM BUCKLE

Close/lock the chin strap - if your helmet configuration includes the red cam buckle, connect both parts of the buckle to lock the chin strap.

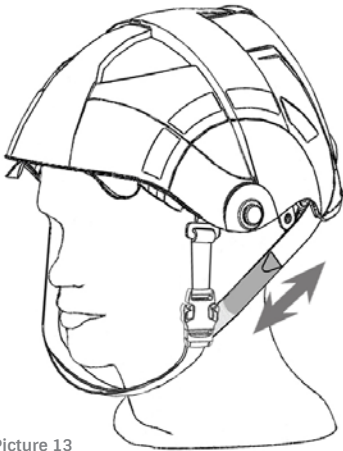

Picture 13

- 7 Adjust the right part of the chin strap: tighten the right part of the chin strap until tight but comfortable. Adjust the plastic rings to secure the strap. To facilitate this step, unfasten the chin strap and remove the helmet from the head.



Picture 15

- 6 Adjust the chin strap: tighten the left part of the chin strap until tight but comfortable. Adjust the plastic rings to secure the strap.

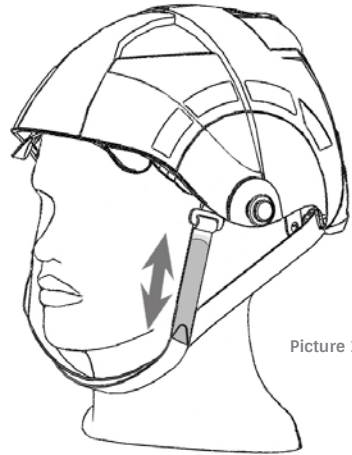

Picture 14

- 8 Adjust the lower part of the chin strap: tighten it until tight but comfortable. Position the plastic rings to secure the strap. To facilitate this step, unfasten the chin strap and remove the helmet from the head.

PAB MP1 Professional

REMOVING THE HELMET

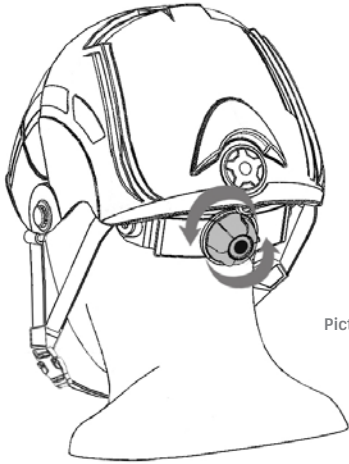

Picture 16

- 1 Loosen the headband: turn the ratchet knob anticlockwise.

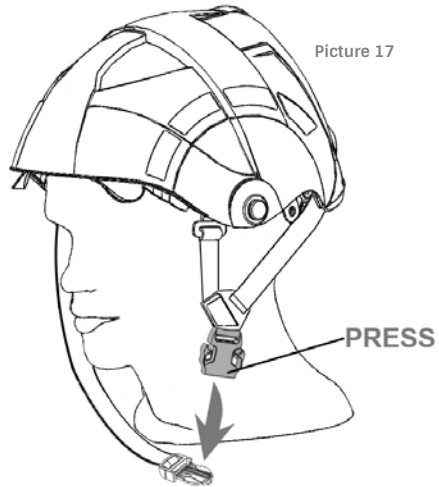

Picture 17

2b SNAP-FIT BUCKLE

Open the chin strap – if your helmet configuration includes a snap-fit buckle, press on both sides of the buckle to open the chin strap and then remove the helmet from the head.

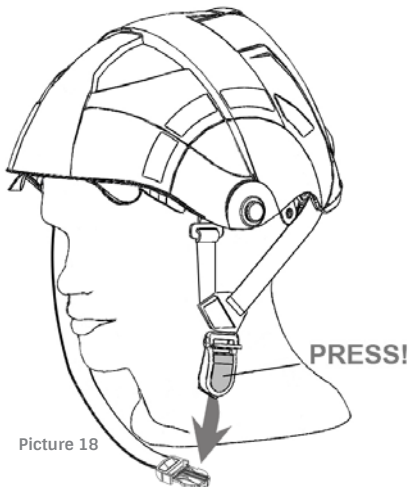

Picture 18

2b CAM BUCKLE

Open the chin strap – if your helmet configuration includes a cam buckle, press the red tab (“PRESS”) to open the chin strap and then remove the helmet from the head.

ADJUSTING THE INTEGRATED INTERNAL GOGGLES AND FACE SHIELD *

(* The face shield is an optional accessory and is not delivered with the helmet unless you have purchased a helmet configuration with face shield.)

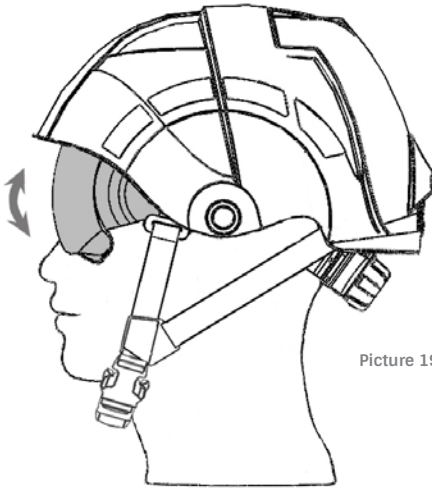

Picture 19

- 1 Position the internal goggles: pull down the goggles into use position. Pull them up again into standby position when not needed.

To facilitate this step and to avoid fingerprints on the goggles use the tabs on the bottom left and right part of the goggles.

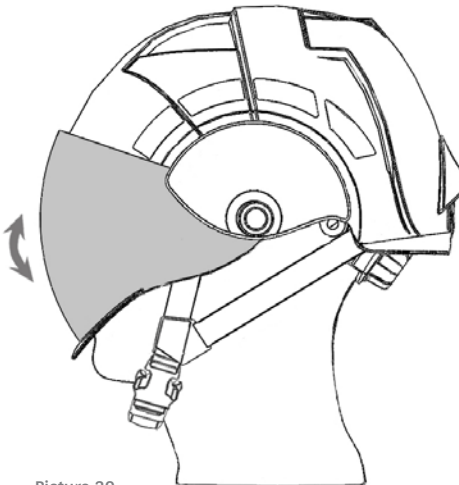

Picture 20

- 2 * If your helmet configuration includes the face shield (visor), position the internal goggles first. Then pull down the face shield into use position or pull it up (over the helmet) into standby position.

To facilitate this step and to avoid fingerprints on the visor use the bulge at the bottom of the face shield.

PAB MP1 Professional



Warning:

The face shield and internal goggles will serve to the intended purpose of face and eye guard only in the use position.

While using the breathing apparatus (SCBA) the face shield and internal goggles should be in the standby position (stored over the helmet).

Face shields worn over non-designated corrective frames may transmit impacts which may damage the corrective eyewear thus creating a hazard to the wearer.

Any scratched, damaged or dropped face shields and goggles shall be replaced.

Materials which may come into contact with the wearer's skin could cause allergic reactions to susceptible individuals.

Equipment not marked with 'T' should only be used at non-extreme ambient temperatures.

Service life of visors depends on the conditions of use.

ATTACHING THE SAFETY GOGGLES*

*Safety goggles are an optional accessory and are not delivered with the helmet unless you have purchased a helmet configuration with safety goggles.

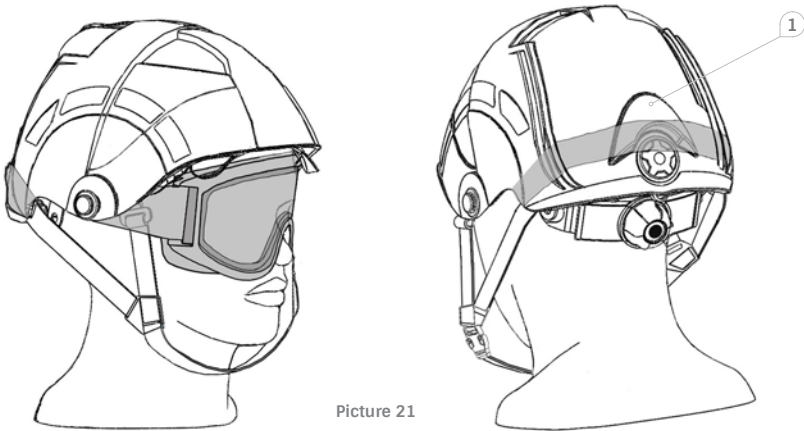

Picture 21

If using safety goggles (sold separately) you can secure them by using the attachment bracket on the back of the helmet (see number 1 on picture 21):

- 1 Place the goggles around the helmet
- 2 Slip the goggle strap under the attachment bracket on the back of the helmet



Warning:

When wearing safety goggles on a helmet with preinstalled internal goggles, the internal goggles must be in standby position!

When using safety goggles, be sure to use safety goggles that comply at least to EN 166 (in accordance to helmet norms EN 16471:2014 and EN 16473:2014).

PAB MP1 Professional

ATTACHING THE NECK PROTECTORS (*Optional)

*Neck protectors are optional accessories. If you purchased the version with a neck protector, please follow the instructions below.

Different versions (leather, aluminised fibre, Nomex or meta-aramid) of standard neck protector for rear protection can be attached. All version can be attached using the 3 snap fasteners (3-point attachment) on the interior part of the shell:

Picture 22

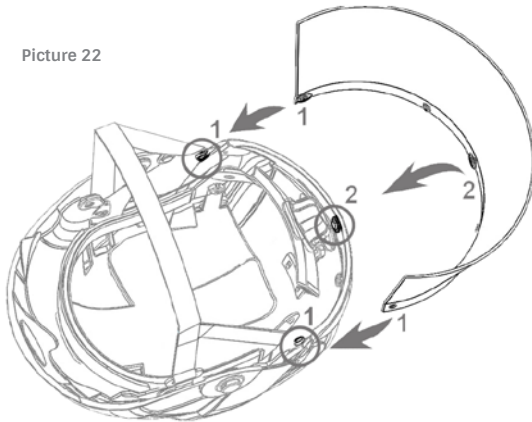

- 1 Attach the neck protector using the 3 snap fasteners on the interior of the helmet's shell:
 - first fasten the neck protector on the snap fasteners on both sides of the helmet (1),
 - then fasten the neck protector on the snap fastener on the rear of the shell (2).

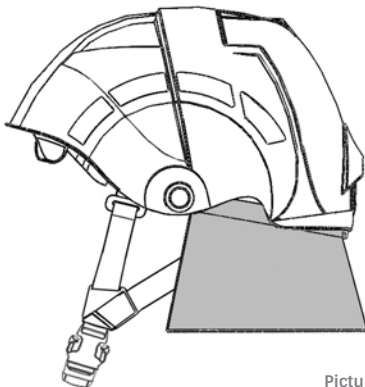

Picture 23

- 2 A helmet with properly fixed standard neck protector.

MOUNTING THE LAMP HOLDERS AND LAMPS (*Optional)

*Lamp holders and lamps are optional accessories. If you purchased a version with a lamp holder and lamp, please follow the instructions below, depending on the type of the lamp.

Different types of lamps can be mounted:

- 2AA or 4AA lamp types
- PELI lamps**

**Only for specific models. Please refer to the manufacturer for more information. For compatibility with other lamp types from other manufacturers please contact PAB Akrapović for more information.

Type I lamp holder (open lamp holder for UK Underwater Kinetics and PELI lamps)

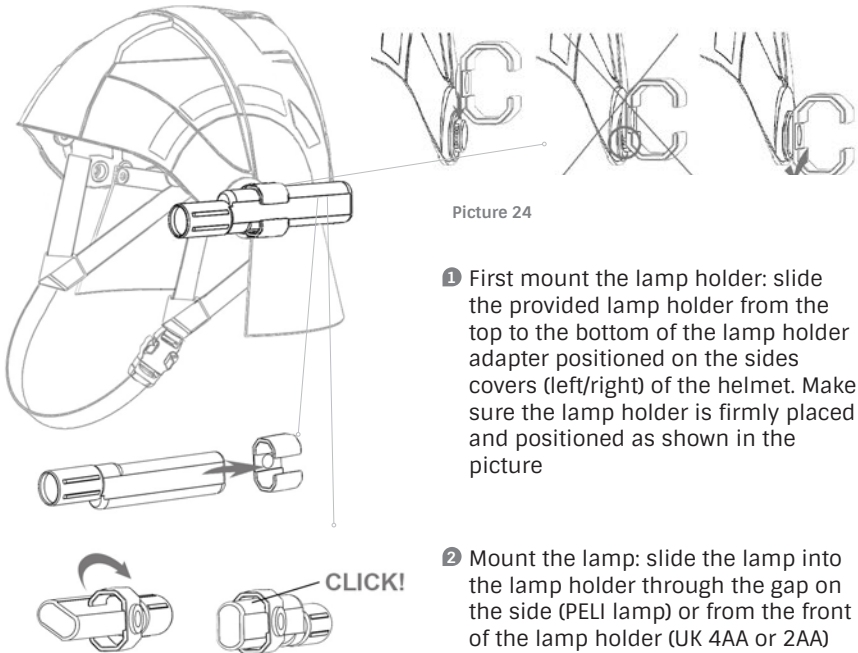

PAB MP1 Professional

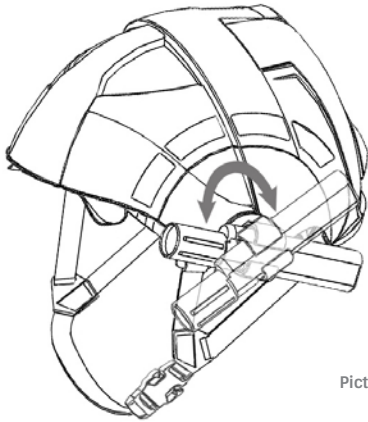

Picture 25

- 3 To adjust the lamp angle, turn the lamp clockwise or counter clockwise

Type II lamp holder (tightening lamp holder)

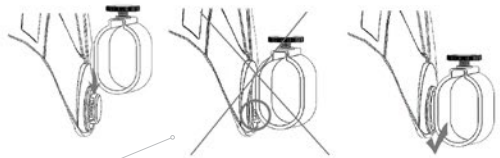
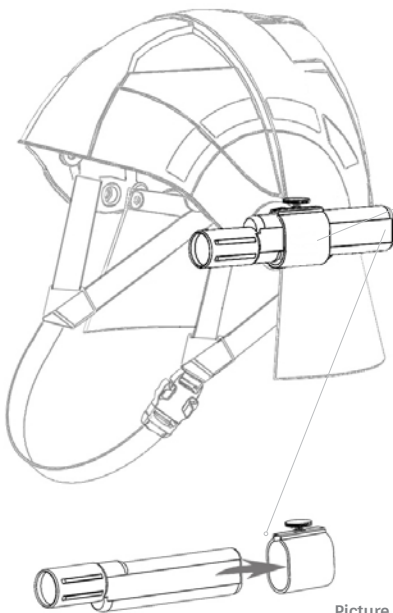

- 1 First mount the lamp holder: slide the provided lamp holder from the top to the bottom of the lamp holder adapter positioned on the sides of the helmet. Make sure the lamp holder is firmly placed and positioned as shown in the picture.
- 2 Mount the lamp: slide the lamp into the lamp holder from the front of the lamp holder (UK 4AA or 2AA) and then tighten the screw on the top of the lamp holder to secure the lamp.

Picture 26

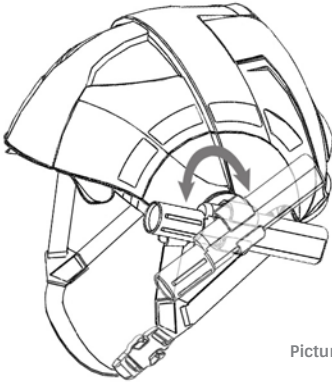

Picture 27

- ③ To adjust the lamp angle, turn the lamp clockwise or counter clockwise.

SERVICING AND MAINTENANCE

The length of the useable life of this helmet will be affected by the types of materials used in its construction and the environments in which the helmet is used and stored. Recommendations on this topic should be sought from the manufacturer.

The helmet absorbs the energy of a blow by partial destruction of, or damage to, the helmet. Even though such damage may not be readily apparent, any helmet subjected to severe impact should be replaced.

An unusual event may require to replace a product after only one use. This depends on the type and intensity of use, or the environment in which it is used: aggressive environments, extreme temperatures, contact with chemicals, strong impacts...

For more details about maintenance and spare parts replacement please contact PAB Akrapović.

PAB MP1 Professional



Warning:

Do not drop the helmet. Prevent impacts to the helmet that could damage (scratch or cause cracks) the internal goggles or face shield (if included in your configuration).

Check regularly the helmet for cracks on the parts in contact with the skin. These damages could cause discomfort.

Do not apply cleaning products on a hydrocarbon base, solvents, paint or stickers to the helmet or visors to prevent damage to the materials of the helmet.

Checks after use

After each use inspect the helmet carefully:

- Check all fixing points: all the components shall be in place and fixed firmly
- Check for any visible cracks or fractures – none shall be evident
- No evident wear
- Check the helmet fit is always correct



Attention:

During the inspection pay special attention to the components listed below that are critical for the safety of the product and replace the product or the component, if any of the described conditions is evident:

- suspension - check for cut or broken stiches, abrasions on straps, discoloration
- shell - check for any cracks, or deep scratches, deformations from mechanical impact or exposure to heat or flames
- chin strap - check for any missing or broken parts, discoloration, cut or broken stitches, worn out straps, broken or missing release buckle
- head band - check if cracked or broken, check if ratchet system does not work properly
- impact liner - check out for any cracks or deformation
- face shield* - if your helmet configuration includes the face shield, check for any cracks, scratches, bubbles, deformations and if does not stay in position

In case of evident damage (impacts, broken parts, significant scratches, torn straps or paddings, coating removal on the shell or visors, missing components, etc.) identified during the regular checks, the helmet shall be sent to a PAB approved maintenance centre for complete control processing.

Only original PAB parts are authorised for replacement and ensure the performance of the helmet. Replace any damaged parts only with original PAB parts.

Periodic checks

PAB Akrapović recommends to execute a complete and detailed inspection of the helmet every two (2) years or more often (e.g. every year) in case of intensive use of the helmet. Execute a detailed check of the helmet every time the helmet has been exposed to severe conditions (direct flame contact, very high temperatures, mechanical impact, contact with chemicals or pouring metal).

Cleaning and disinfection

SHELL AND PLASTIC COMPONENTS: use soapy water and a soft cloth. Do not use detergents, solvent based products or abrasive materials.

INTERNAL GOGGLES: use soapy water and a soft cloth. Do not use detergents, solvent based products or abrasive materials.

FACE SHIELD*: if your configuration includes the face shield, use soapy water and a soft cloth to clean it. Do not use detergents, solvent based products or abrasive materials.

CHIN STRAPS: use soapy water and a soft cloth. ☒

HEAD PADDING, HEAD BAND PADDING, NECK PIECE: you can remove these parts for an easier cleaning (see picture).

Please do not remove the interior basket to perform this step!

PAB MP1 Professional

Open the Velcro fasteners and clean the individual pieces:

- Leather head band padding and neck piece: use soapy water and a soft cloth ☒
- Head padding: hand-wash in cold water and a mild detergent. Rinse with water and let dry. ☒☒☒☒☒☒

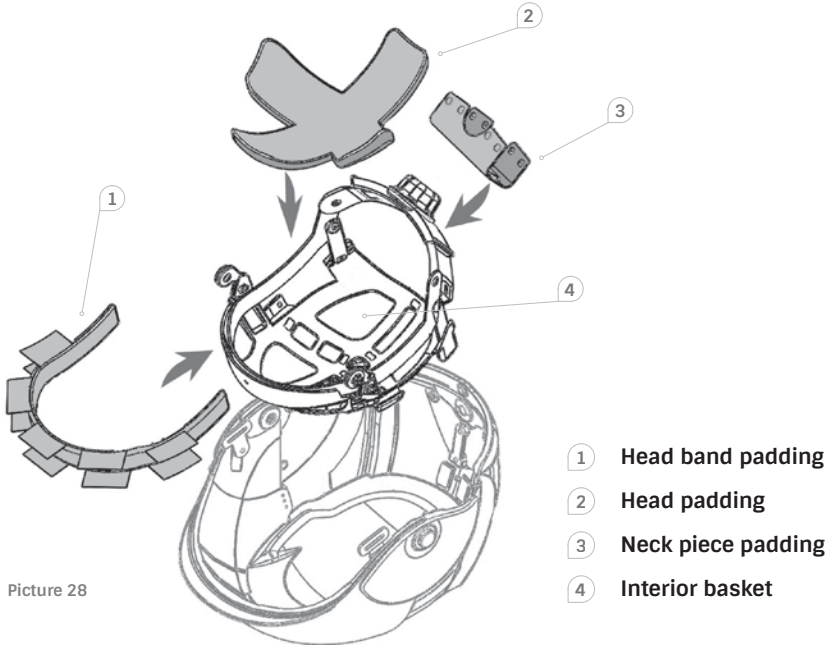

Picture 28

Note: do not remove the interior basket from the shell!!

NECK PROTECTORS:

- Neck protectors made of Nomex, or meta-aramid: cleaning at 30°C with a gentle detergent ☒☒☒☒☒☒
- Leather or aluminised neck protectors: cleaning at 30°C with water using a sponge ☒

For cleaning, maintenance or disinfection, use only substances that have no adverse effect on the helmet and are not known to be likely to have any adverse effect upon the wearer, when applied in accordance with the manufacturer's instructions and information.

FACE SHIELD REPLACEMENT

*The face shield is an optional accessory. In case your configuration includes a face shield and if it needs to be replaced, please follow the following instructions:

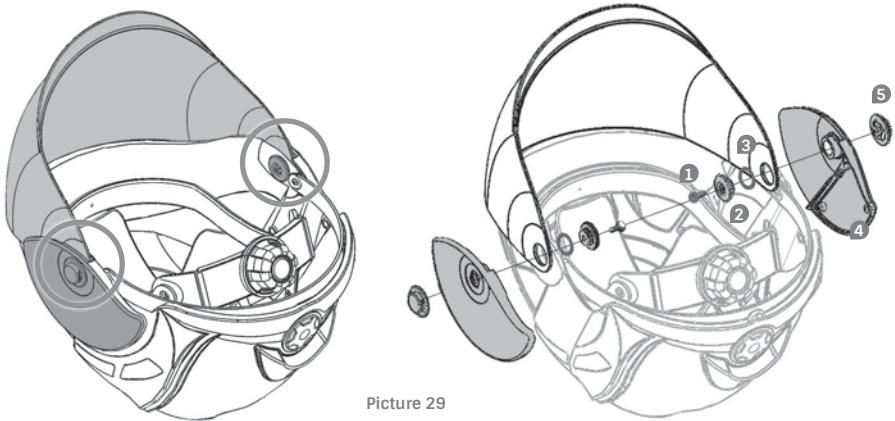

Picture 29

- 1 Using a cross-tip screwdriver loosen the 2 screws on the inner sides of the shell (see Picture 29).
- 2 Carefully disassemble all the parts: screw (1), inner plastic protector (2), gasket (3), side covers (4), lamp holder adapters (5), and remove the old face shield from its position.
- 3 Place the new face shield on the side holes and carefully reassemble all the parts: screw (1), inner plastic protector (2), gasket (3), side covers (4) and lamp holder adapters (5), to their original positions. Secure the visor and all the parts with a crosstip screwdriver.
- 4 Before wearing the helmet, check if the face shield is properly fixed – the face shield should slide smoothly between standby and use positions.

For more information, please check regularly our website www.pab.hr or contact directly PAB Akrapović d.o.o.

PAB MP1 Professional

STORAGE AND TRANSPORT

STORAGE

To extend the lifetime of this product to the maximum:

- Store the helmet in its storage bag and/or in a closed cabinet to prevent extended exposure to cold, heat, humidity, light, exhaust fumes...
- After use and before storing clean the helmet(the shell and all other components).

TRANSPORT

Before transport put the face shield and/or the goggles in standby position and place the helmet in a PAB protective textile bag.

FACE SHIELDS AND GOGGLES AS SPARE PART

The face shields and goggles shall be stored and transported in their plastic bags until mounted on the helmet.

SERVICE LIFE AND DISCARD

PAB helmets do not have a limited service life expectancy as it is variable and strongly depends on the conditions of use, maintenance and storage of the product. PAB helmets are very resistant to ageing, with a minimal expected service life of 10 years, but only if provided that they are used, stored, maintained and serviced properly. Exposure to extreme temperatures, strong impacts, corrosive chemicals, flames or aggressive environments have a significant impact on the service life of the product. Inspect and clean carefully the helmet after each use and replace any damaged parts or products. To ensure a lifetime as long as possible please follow the instructions, information and recommendations stated in this user manual.

When the helmet or its parts become obsolete or irreparably damaged, the helmet and its parts shall be treated as ordinary non-hazardous industrial waste according to local regulations.

For further information, please contact PAB Akrapović.

WARRANTY

The product warranty period for PAB helmets and helmet's optional accessories produced by PAB Akrapović is two (2) years.

PAB Akrapović guarantees that the delivered PAB products will conform to their technical specifications and will be free from defects in materials and workmanship. This warranty does not apply to helmets and optional accessories which are misused, or abused, or damaged from installation of accessories not produced by PAB Akrapović, or not used in accordance with user manual.

PAB helmets and accessories provide protection for the wearer's head during exposure to extreme conditions (aggressive environments, extreme temperatures, flame, corrosive chemicals, strong impacts) and during use of the helmet under the described conditions, the helmet and/or accessories may get irreparably damaged. Damages that are caused by use under the described conditions are not covered by our product warranty.

PAB Akrapović product warranty does not cover, and does not make any warranty with respect to any defect, failure, deficiency, or error which is:

- not timely reported to the producer; or
- due to misapplication, modification; or
- due to dirt or exposure to extreme conditions; or
- due to operation, either intentional or otherwise, in an improper manner.

PAB MP1 Professional



PAB Akrapović

EU DECLARATION OF CONFORMITY

1. Personal Protective Equipment (PPE):

Helmet PAB MP1 Professional

2. Name and address of the manufacturer:

PAB Akrapović d.o.o.
Most 26
52420 Buzet
Croatia

3. This declaration of conformity is issued under the sole responsibility of the manufacturer:

PAB Akrapović d.o.o., Most 26, 52420 Buzet, Croatia

4. Object of the declaration:

Helmet for wildland firefighting, technical rescue, industrial use, mountaineering, canoeing and white-water sports model PAB MP1 Professional, optionally available with visor model PAB Fire Compact and integrated goggles model Goggle 04

5. The object of the declaration described in point 4 is in conformity with the relevant Union harmonisation legislation:

Regulation (EU) 2016/425 of the European Parliament and of the Council of the European Union of 9 March 2016 on personal protective equipment

6. References to the relevant standards used:

EN 16471:2014
EN 16473:2014
EN 12492:2012
EN 1385:2012
EN 397:2012+A1 (2012) clauses: 5.1.1, 5.1.2, 5.1.3, 5.2.1, 5.2.2, 5.2.3, 5.2.4 and 5.2.5

7. The notified body **CSI S.p.A., Viale Lombardia 20/B, 20021, Bollate (MI), Italy**, notified body number **0497** performed the Category III EU type-examination (Module B) and issued the EU type-examination certificate **DPI/0497/1168**.

8. The PPE is subject to the conformity assessment procedure based on internal production control plus supervised product checks at random intervals (Module C2) under surveillance of the notified body **CSI S.p.A.**, notified body number **0497**.

Signed for and on behalf of:

PAB Akrapović d.o.o. in Buzet  PAB Akrapović d.o.o.
Most 26,
52420 Buzet, Croatia (4)

Miha Akrapović, General Manager of PAB Akrapović d.o.o.
PAB Akrapović d.o.o.
Most 26, 52420 Buzet, Croatia
T +385 52 662 662 | F +385 52 662 254 | info@pab.hr | www.pab.hr | VAT No. HR36705813625

BANK COORDINATES:
Bank: ISTARSKA KREDITNA BANKA d.d. UMAG | Swift code: ISKBHR 2X | IBAN: HR2623800061149004450



PAB Akrapović

Your PAB Akrapović partner:

PAB Akrapović

Most 26, HR-52420 Buzet, Croatia

P +385 52 662 662

info@pab.hr | www.pab.hr